

Android - eduroam configuration

The following instructions apply to using the Eduroam wireless service on the Android device

From the home screen, tap the arrow to open the **All Programs** menu



Tap **Settings** from the programs menu



Tap **Wireless Controls**

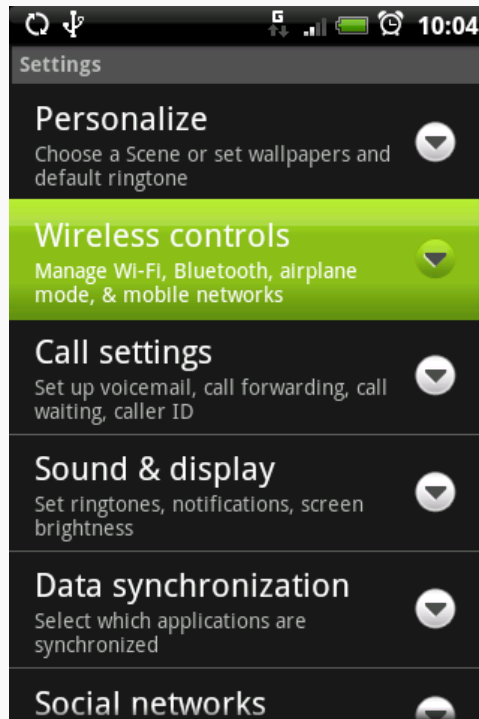

Tap **Wi-Fi Settings**

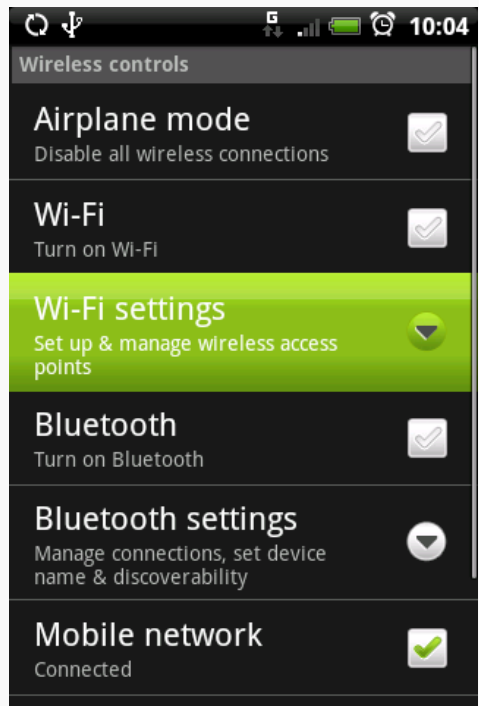

Tap **Wi-Fi** to enable Wi-Fi support - the list of networks will become populated

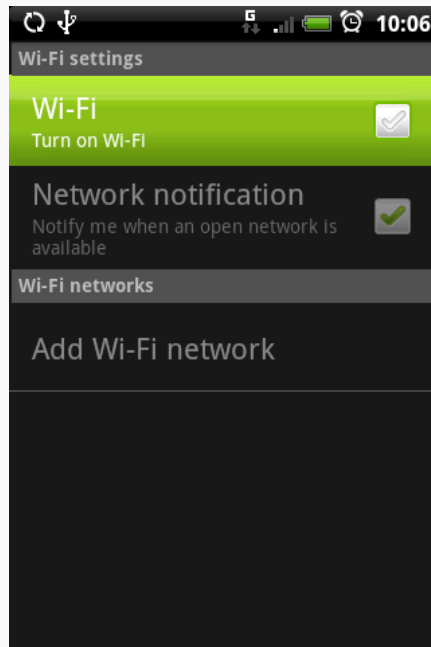

Tap the **eduroam** entry in the list

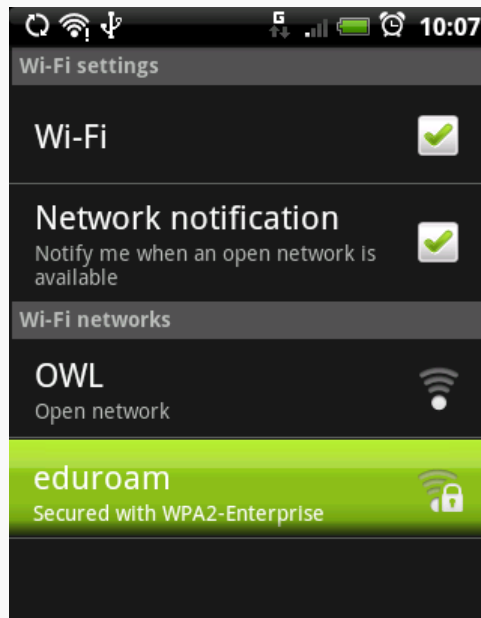

Tap to change the EAP type to **PEAP**

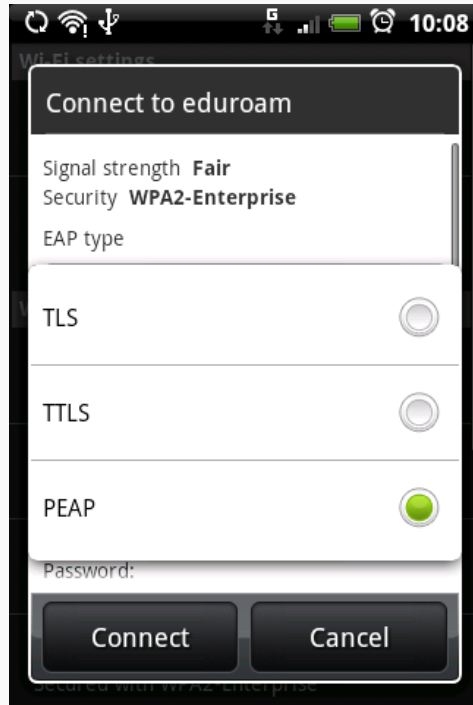

Tap to set the Sub-type to **PEAPv0/MSCHAPv2** (this ought to be the default)

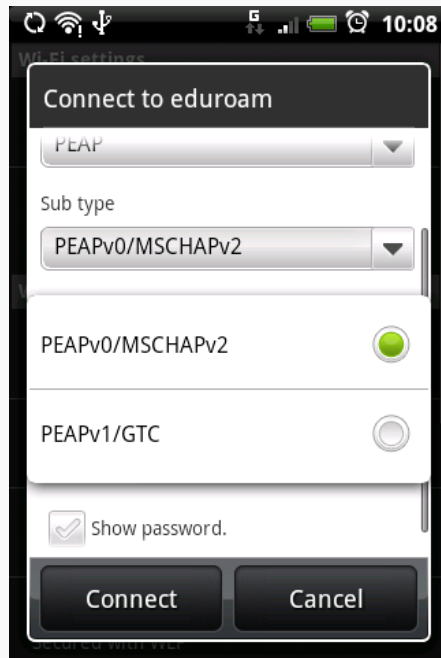

Enter your *username* followed by *@jkuat.ac.ke* in the User name field (for example *username@jkuat.ac.ke*)

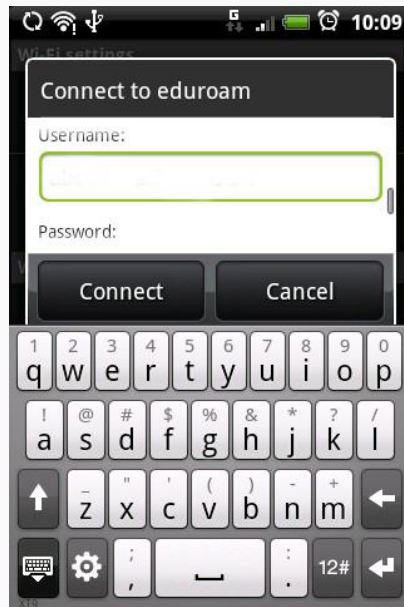

On some mobiles you will also see an **Anonymous identity box**. Add in your Remote Access account username again followed by @jkuat.ac.ke e.g. username@jkuat.ac.ke

Enter your password in the **Password field**



Hit the **Connect** button

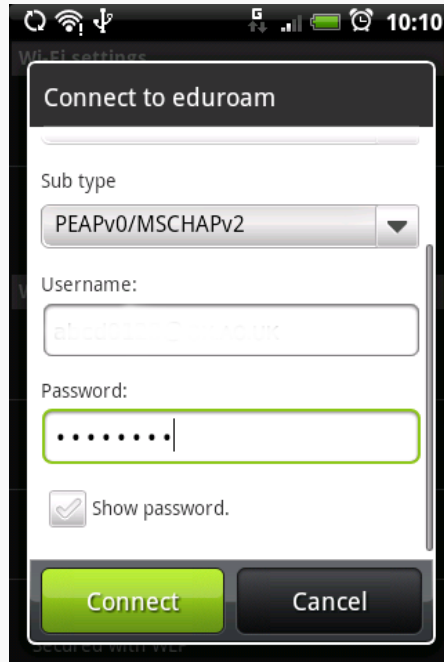

Wait a little while (up to about a minute) until the message "**Connected to eduroam**" appears

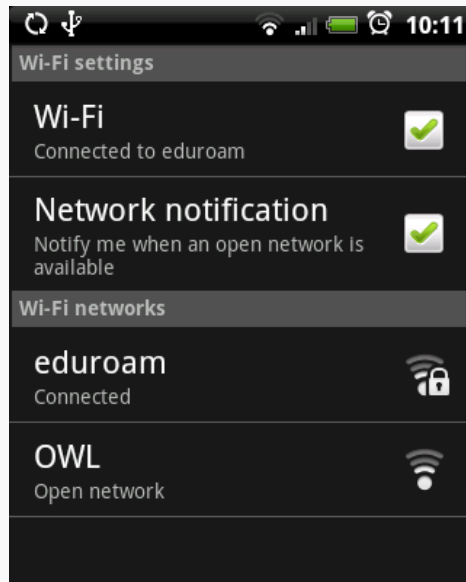

A connection to eduroam will automatically be made in future if Wi-Fi is switched on and you are within range.